

**ATTENTION!** King size sleeper can be assembled on either side. Process is same, only change is what arm is removed and mirror the process.

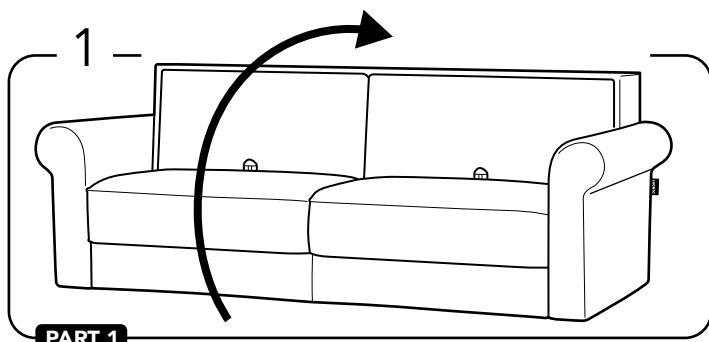

Turn the bed to the backside.

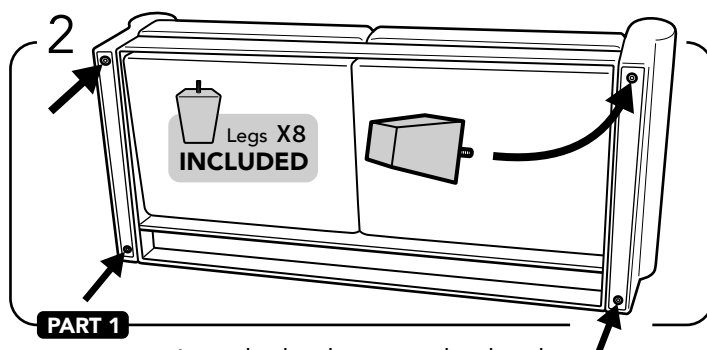

Attach the legs to the bed.

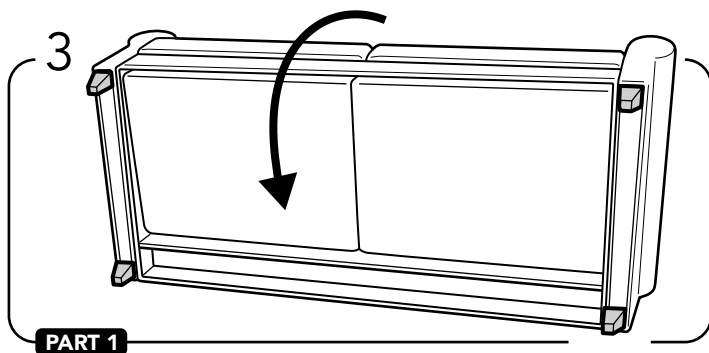

Lift up and put the bed to the legs.

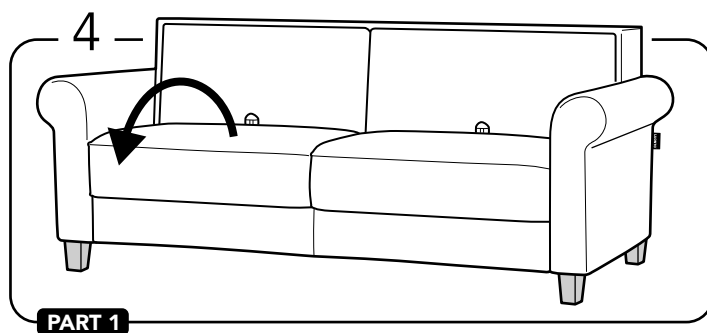

Open the bed mechanism part.

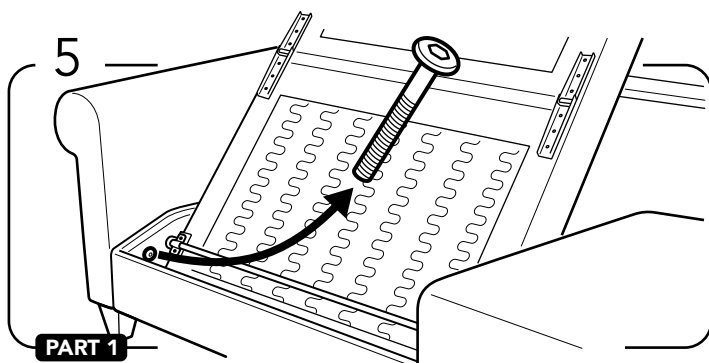

Remove the frontside armrest fixing bolt.

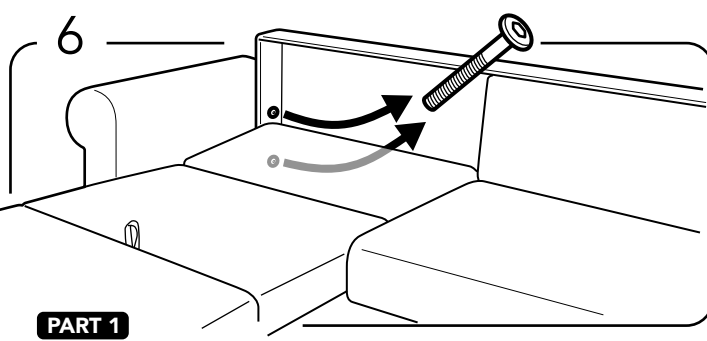

Put down the bed mechanism and remove 2 backrest fixing bolts.

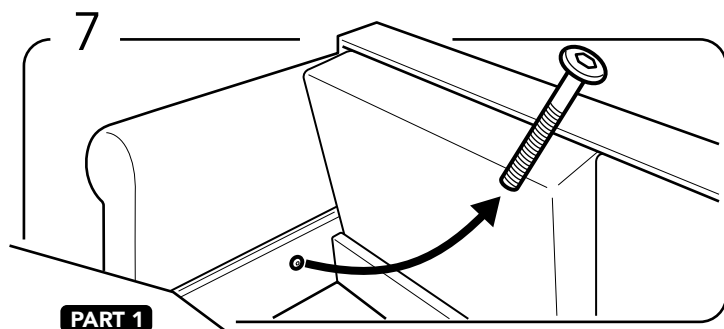

Lift up the backside bed part and remove the last armrest fixating bolt.

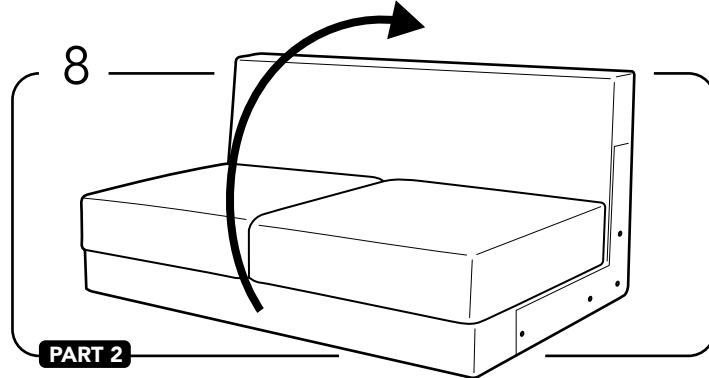

Turn the stationery to the backside.

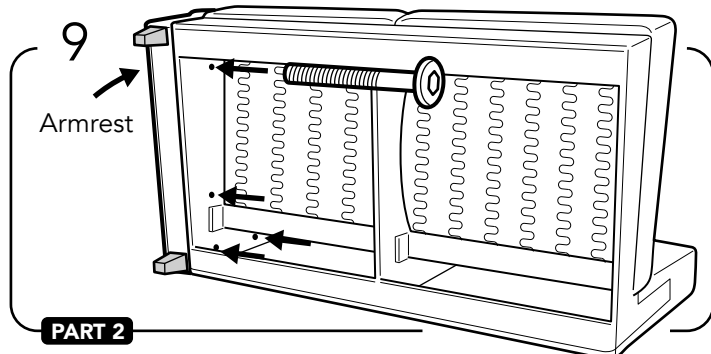

Fix the armrest from inside the stationery with four (M6 x 55 bolts).

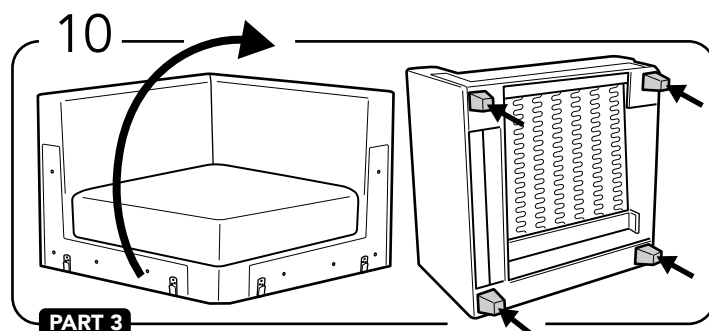

Turn the corner to the backside, Then insert the 4 legs.

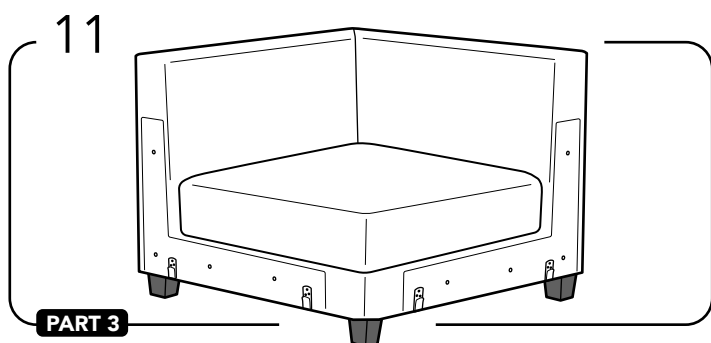

Lift up and put the corner to the legs.

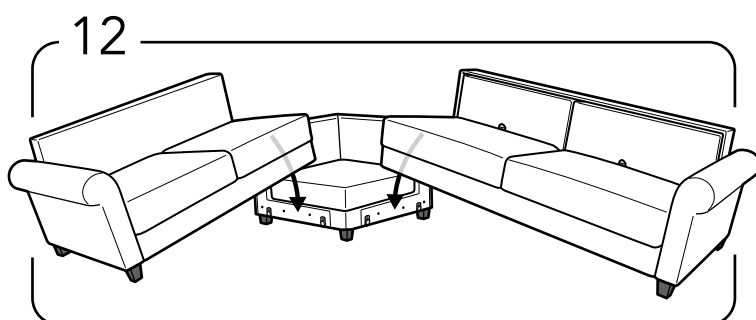

Attache the bed and the stationery parts to the corner part inside the pre-installed anchors.

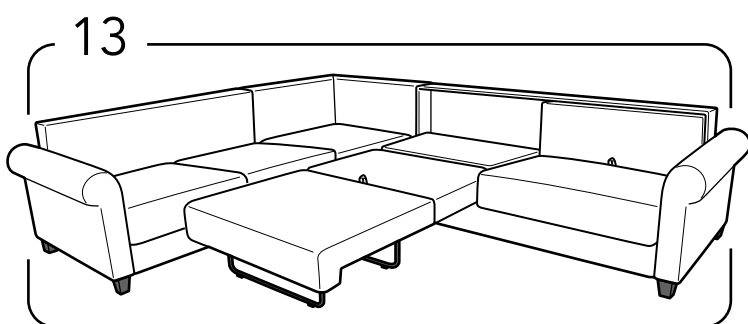

Open the bed mechanism.

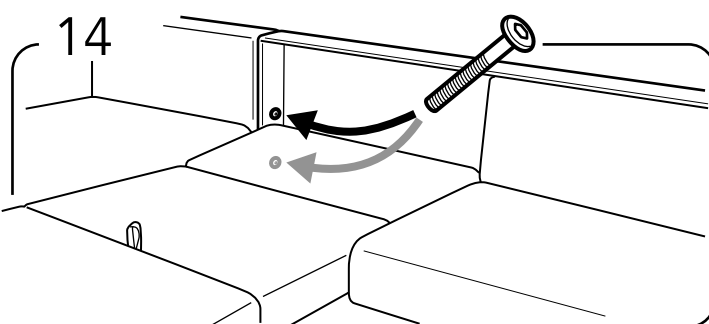

Put down the bed headside part and attach the bed backside to the corner part.

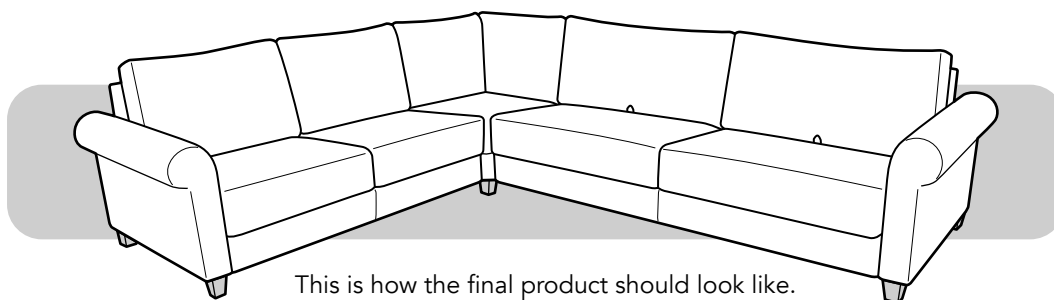

This is how the final product should look like.